

CUSTOMER PART No.

CUSTOMER

# CAN ART STD.

DIE No.

EH05236

DESCRIPTION

2" SCHEDULE 40 PIPE

PROPOSAL No.

H-1718

NOTE: BREAK ALL CORNERS WITH 0.015" (.38 MM) RADIUS UNLESS OTHERWISE NOTED. STANDARD TOLERANCES TO APPLY UNLESS OTHERWISE SPECIFIED.

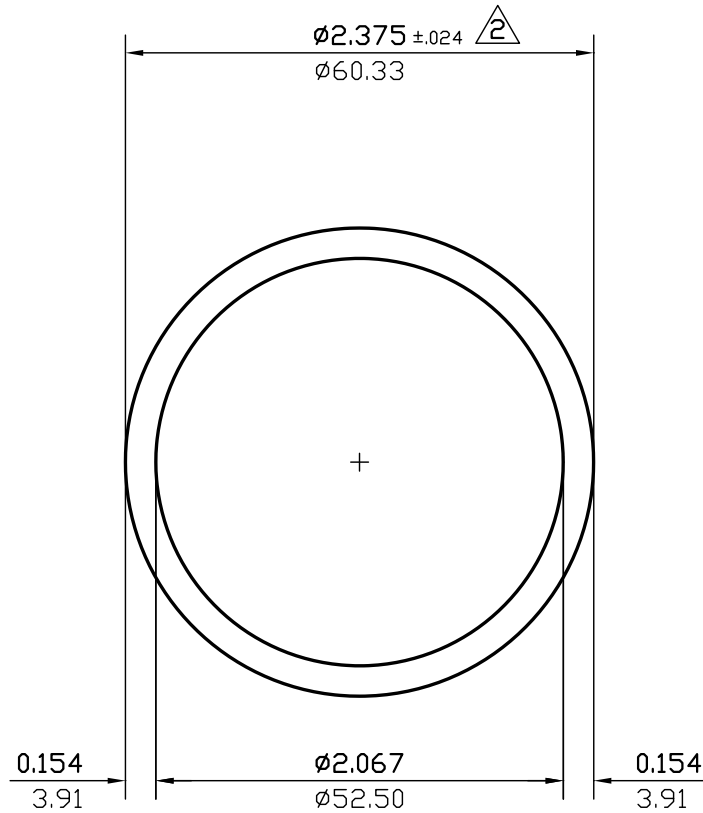

WALL THICKNESS 0.154 (3.91) EXCEPT AS SHOWN

DATE	REV	DESCRIPTION	BY		
03/10/23	3	REMOVED ALLOY	JASON		
07/13/15	2	REVISED TOLERANCE FROM $\pm .025$ TO $\pm .024$ . REMOVED HOUSING/INSERT NOTE.	P.M.		
EST.AREA	1.075	IN. <sup>2</sup>	EST.AREA	693	MM. <sup>2</sup>
EST.WT.	1.268	LBS./FT.	EST.WT.	1.887	KG/M.
EST.PER.	13.955	IN.	EST.PER.	354.5	MM.
OUT PER.	7.461	IN.	OUT PER.	189.5	MM.
C.C.D.	2.375	IN.	C.C.D.	60	MM.
FACTOR	11	FINISH	M/F	ALLOY & TEMP.	
CKD BY		SCALE	1:1	DWN BY	G.M. DATE 10/01/90

## CAN ART

ALUMINUM EXTRUSION INC.

85 PARKSHORE DRIVE  
BRAMPTON, ONT L6T 5M1  
TEL. NO. (905) 791-1464  
FAX NO. (905) 791-9151  
E-MAIL: canart@canart.com

THIS DRAWING IS NOT NECESSARILY A COPY OF YOUR ORIGINAL. PLEASE APPROVE DIMENSIONS AND TOLERANCES INDICATED. CAN ART ASSUMES NO RESPONSIBILITY EITHER TECHNICAL OR LEGAL FOR HAVING THIS SHAPE MADE. THE CUSTOMER AGREES TO FULLY PROTECT CAN ART ALUMINUM FROM CLAIMS OF OTHERS RESULTING FROM THIS SHAPE.

SIGNED: \_\_\_\_\_ DATE: \_\_\_\_\_